

NOWPak[®] NA-136 Type PFA Replacement Breakseal

PFA replacement breakseal

All PFA, pre-cleaned, solid-construction replacement breakseals enable refurbishment of NOWPak[®] canister system two-piece NC- and NCE-type aluminum closures. The fully molded PFA breakseal design ensures optimal cleanliness and performance.

APPLICATIONS

- Designed for applications where aggressive chemistries are used, and where superior cleanliness is required

FEATURES & BENEFITS

All PFA injection molded breakseal design	Provides improved cleanliness. Molded design resists warping, and eliminates the possibility of delamination.
Rounded, serrated edge construction	Allows for easy, snap-in insertion and improved retention in closures.
Wetted surface channel design	Creates secure placement and seal with the liner fitment.

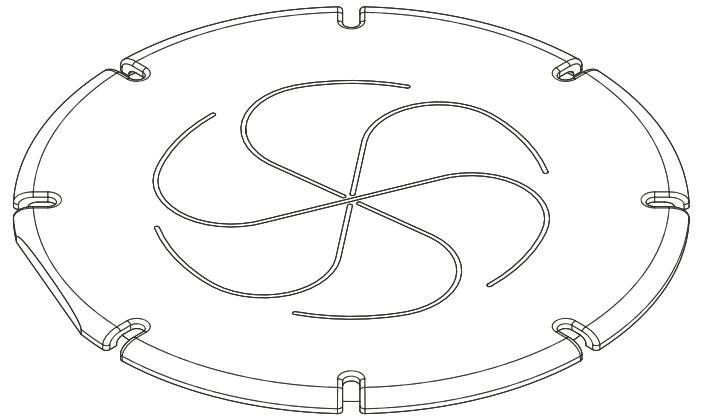

NA-136 – top view of breakseal with score lines, non-wetted side.

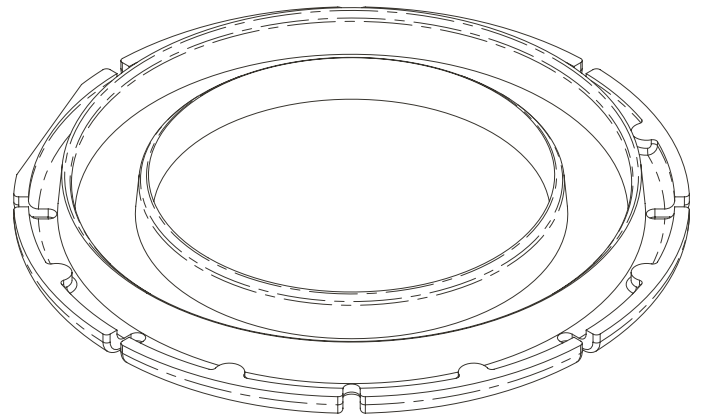

NA-136 – bottom view of breakseal, wetted side.

SPECIFICATIONS

Part numbers	NA-136-50 and NA-136-500		
Materials of construction	Breakseal	Injection molded PFA	
Weight	2 grams, nominal		
Manufacturing standards	Cleaned and packaged in a Class 5 Cleanroom as per International Standard ISO 14644-1:* Cleanrooms and associated controlled environments – Part 1: Classification of air cleanliness.		
Cleanliness	Breakseals to be free from lubricants and other extraneous foreign materials consistent with Entegris' processes and procedures.		
Packaging	Breakseals are bulk packaged in quantities of 50 or 500. Bulk packaging consists of a heat sealed, cleanroom processed PE inner bag and a heat sealed PE outer bag. Double bagged breakseals are then packaged in a corrugated shipping carton.		
Labeling	Each bulk package of breakseals is labeled with the part number, batch number, and quantity of breakseals. The label is placed on both the PE outer bag inside the box, and on the exterior of the corrugated shipping carton.		
Shipping information	Part number	Box quantity	Box dimensions (L x W x H)
	NA-136-50	50	310 mm x 210 mm x 165 mm (12.00" x 8.25" x 6.50")
	NA-136-500	500	310 mm x 210 mm x 165 mm (12.00" x 8.25" x 6.50")

**ISO standard certification is kept up to date as necessary to remain current and effective to be able to demonstrate compliance with up-to-date ISO requirements.*

DIMENSIONS

Top view with score lines

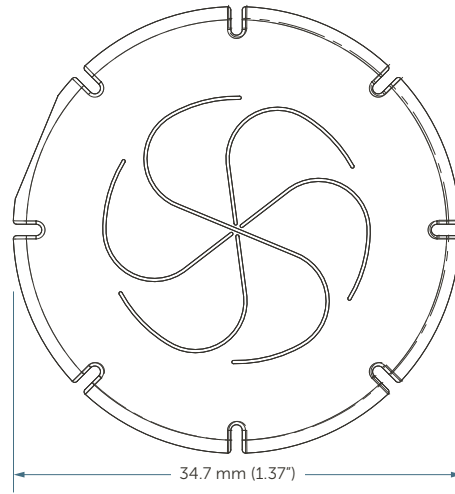
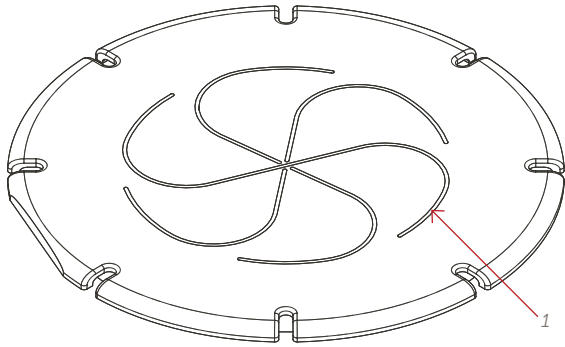

Bottom view

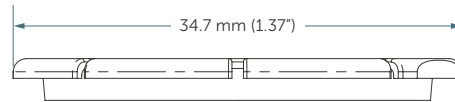
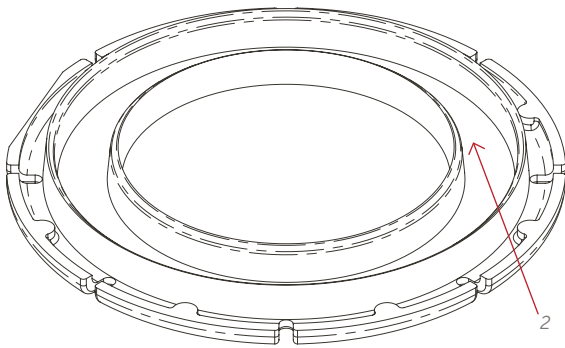

Item	Item description	Quantity
1	Scoring for break-through	1
2	PFA breakseal with sealing channel	1

BREAKSEAL PLACEMENT

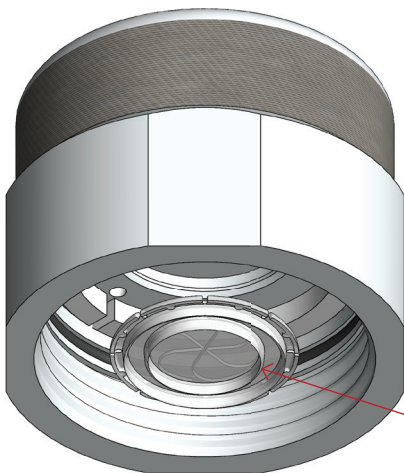

Correct placement of breakseal

IMPORTANT! When inserting the replacement breakseal into the closure body, the top, scored line side of the breakseal is placed in contact with the closure, and the bottom view side remains exposed until the closure is placed onto the container and seals over the liner fitment. When properly inserted, the breakseal snaps securely into place. If inserted incorrectly, the closure will not seat properly onto the liner fitment and leakage could occur.

